

Location of System Infrastructure Shown in Photos

Photo 1: The ICR Pump House is at 14000 Grey Bears Trail. It is used as a meeting place and for document storage.

Photo 2: The two ICR Wells are located west of Williamson Valley Road near the junction with Punteeney Road (North of the Firehouse).

Photo 3: The ICR Tank is on Magner Road. Water from the wells is first pumped to this tank.

Photo 4: The WC Boost Station is on Grey Bears Trail adjacent to the Sanitary District plant. This station pumps water from the tank on Magner Road to the WC Tank.

Photo 5: The WC Tank is on the hill south of Whispering Canyons Drive. This tank supplies water to the ICR, Preserve and Whispering Canyons sub-divisions by gravity feed.

Photo 6: The three TRR Wells are located east of Williamson Valley Road near the junction with Punteeney Road (North of the Firehouse).

Photos 7 & 8: The TRR Tank is located east of Williamson Valley Road north of the Firehouse. Water from the TRR wells is pumped to this tank. Pumps at this station pump the water to Talking Rock residents and Golf Course. This is called the Cooper Morgan Station.

Photo 9: The Double Adobe Boost Station is located near the corner of Double Adobe and Three Forks Roads in Talking Rock. It supplies additional pumping pressure for TRR residents.

Photo 10: The TRR Tank at 4965 Three Forks Road provides storage and pumping to parts of Talking Rock. It is fed from the Double Adobe Boost Station.



ICR Pump House
Monthly Meetings
14000 Grey Bears Trail



ICR Wells



ICR Tank
Magner Rd



WC Boost Station
Located West of Grey Bears
Trail



Talking Rock Wells



WC Storage Tank

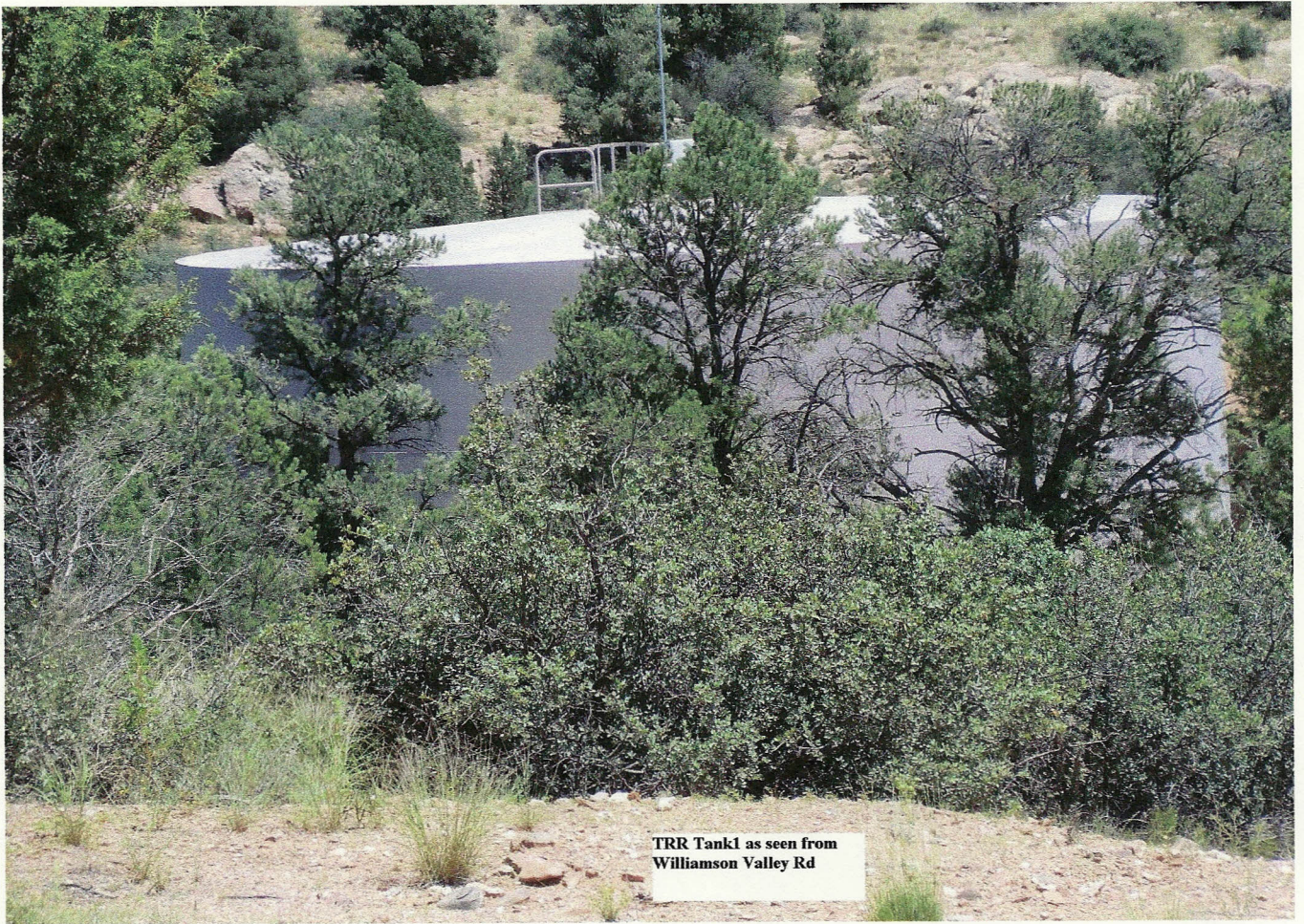

TRR Tank1 as seen from
Williamson Valley Rd

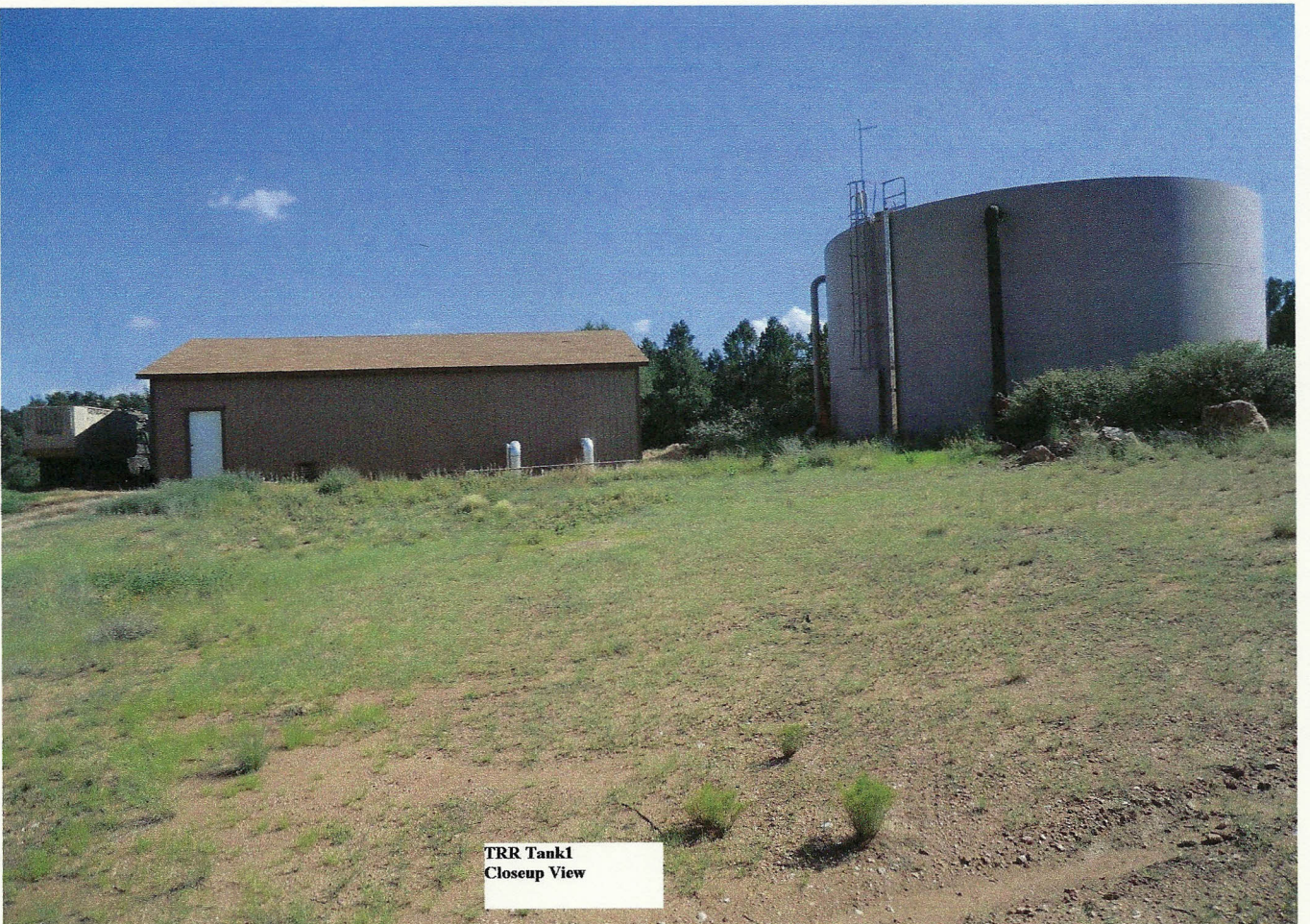

TRR Tank1
Closeup View

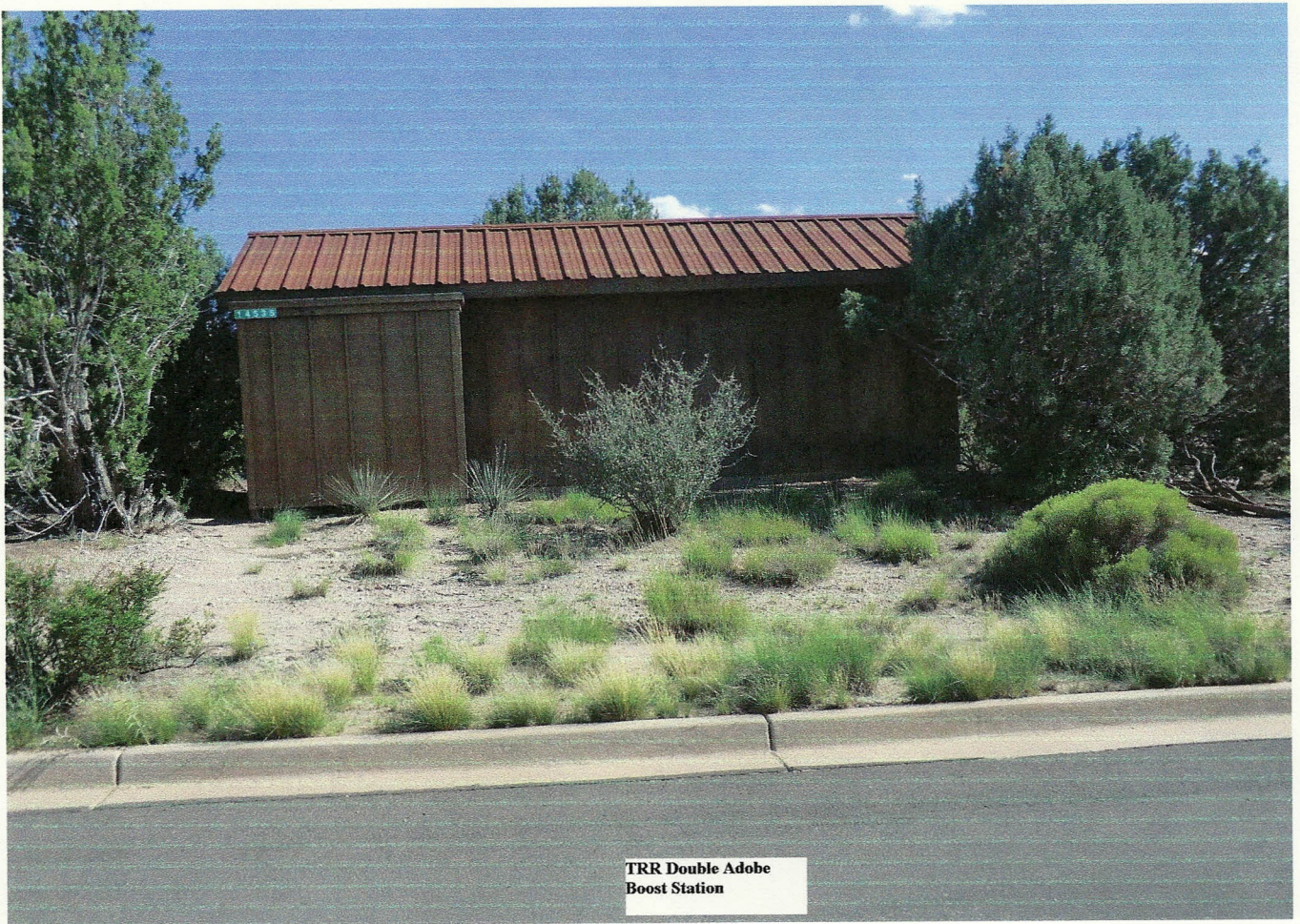

TRR Double Adobe
Boost Station



TRR Tank2
at 4965 W Three Forks Rd